

LOTS 6, 7, & 8, BLOCK 2, NORTHERN PACIFIC RAILWAY COMPANY-RONALD TOWNSITE
 WITHIN THE SW1/4 OF THE SW1/4 OF SECTION 07, TOWNSHIP 20 NORTH, RANGE 15 EAST, W.M., KITTITAS COUNTY, WASHINGTON

FOUND MONUMENT,
 A 3" BRASS DISK ON
 R.O.W. CENTERLINE,
 STAMPED, "KCPW LS 51802"

FOUND 5/8"
 REBAR & CAP
 "KAP LS 49286"

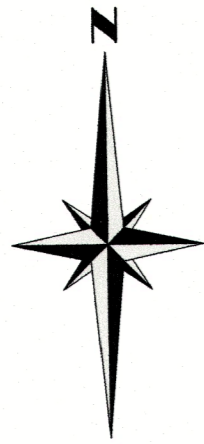

0 10' 20' 40'
 SCALE: 1" = 20'

FOUND MONUMENT,
 A 3" BRASS DISK ON
 R.O.W. CENTERLINE,
 STAMPED, "KCPW LS 51802"

FOUND PYRAMID
 MONUMENT
 12 07
 13 18

(MONUMENTED SECTION LINE PER R5)
 2648.35'

714.27'

29.08'

29.08'

314.05' TO INTERSECTION 2ND STREET

(SOUTH BOUNDARY OF RONALD TOWNSITE, PER PLAT)

SET 5/8" REBAR W/CAP, LS 52843,
 UPON APPROVAL OF BOUNDARY LINE
 ADJUSTMENT APPLICATION (TYP.) N89°44'51"W 116.32'

INDEX LOCATION
 SEC. 07, T.20N., R.15E., W.M.

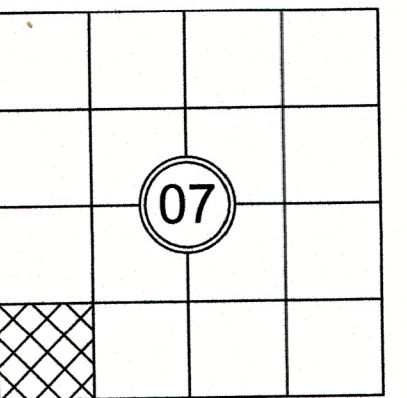

AUDITOR'S CERTIFICATE

FILED FOR RECORD, THIS _____ DAY OF _____, 2020,
 AT _____ M., IN BOOK _____ OF SURVEYS AT PAGE _____
 AT THE REQUEST OF APS SURVEY & MAPPING, INC.

JERALD V. PETTIT
 COUNTY AUDITOR
 DEPUTY AUDITOR



SURVEYOR'S CERTIFICATE

THIS MAP CORRECTLY REPRESENTS A SURVEY MADE BY
 ME OR UNDER MY DIRECTION IN CONFORMANCE WITH THE
 REQUIREMENTS OF THE SURVEY RECORDING ACT AT THE
 REQUEST OF JOSHUA STUTZ, IN JULY OF 2020.

SAMUEL R. WARD, PLS DATE _____
 STATE OF WASHINGTON CERTIFICATE NO. 52843

BOUNDARY LINE ADJUSTMENT NO. _____

LOTS 6, 7, & 8, BLOCK 2, NORTHERN PACIFIC RAILWAY COMPANY
 RONALD TOWNSITE
 PREPARED FOR
 JOSHUA STUTZ

SURVEYED BY: JC	DRAWN BY: MAGG	CHECKED BY: VW	APPROVED BY: SRW
DATE: NOV. 2020	APSSM JOB NO.: 1938002	ACAD NAME: 1938002BLA (2018).DWG	

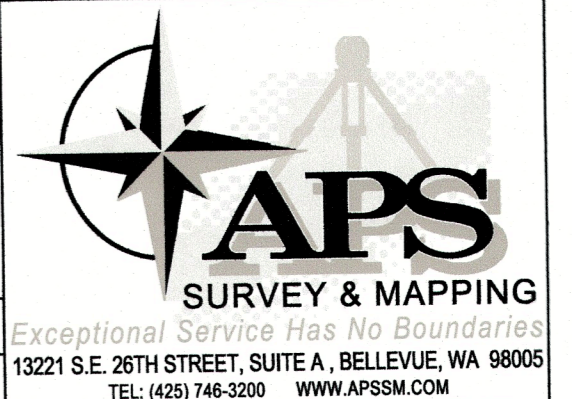

SHEET

2
 OF
 2